

Load Monitoring - Crane Scales

Ron 2125 Hook Type Crane Scale with 1"/25mm Attachable Display

ADVANTAGES



5 year warranty

Portable: Lightweight and small.

Highly Accurate: $\pm 0.1\%$ of full range - important for early overload detection.

Readable: Larger digits and backlit display

Flexible: Indicator can be hand-held or attached to load cell (up to 12.5t).

Excellent battery life: Up to 2000 Hours (3x AA batteries)

Quality Materials: Exclusive use of high strength aerospace quality steel for load cell bodies.

Fatigue rated: All Eilon Engineering load cells are Fatigue Rated according to ASME BTH-1 and IEC 61508. Fatigue Rated means an unlimited number of load cycles (Provided capacity is not exceeded).

Robust: Heavy duty designs with shock absorbing mechanisms.

Minimal Headroom loss: Smallest on the market - important for indoor applications.

Advanced options: Auto/Manual Data Logger, RS232, Additional Displays.

Short delivery time: In most cases 48-72 hours.

More than 45 years in the market with repeat customers such as NASA, Boeing, Cirque du Soleil, Disney, GE, Lockheed Martin, other Fortune 500 companies, as well as numerous small businesses.



TECHNICAL SPECIFICATIONS



Safety factor: Load cell body - 5:1. Hook - at least 4:1

Accuracy: 0.1% of full range.

Calibration: User calibration. Initial factory calibration, fully traceable (certified).

Load Cell Material: high-strength, aerospace quality, alloy steel, polyurethane coated.

Proof Load: Each system proof-loaded to 200% of capacity (certified)

Display: 6 digits, 1" (25mm) liquid crystal display. Overload warnings (100%/130%), Max (peak hold), low battery indication, Gross/Net. Refresh rate 1Hz.

Cable: 15" / 5m cable.

Sampling Rate: 200 per second.

Functions: Zero. Tare. Battery charge level indication. Low battery warning. Max. (peak hold). Sleep mode, wakes automatically when loaded.

Units: User selectable units (metric tons, short tons, kgs., lbs., Newtons, Deca-Newtons, Kilo-Newtons).

Housing: Aluminum indicator, ABS load cell.

Temperature Range:

Load cell: -15°F to $+175^{\circ}\text{F}$ (-25°C to $+80^{\circ}\text{C}$).

Indicator: -4°F to $+158^{\circ}\text{F}$ (-20°C to $+70^{\circ}\text{C}$).

Environmental: IP65 (Optional IP67 Load Cell).

Capacities 0.5t - 15t
(Clevis Hook)

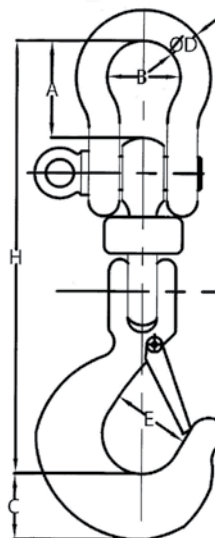

Capacities 20t - 30t
(Eye Hook)

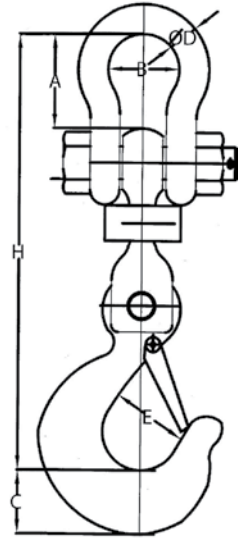

Cat no.	Capacity		Resolution		Cable length		A		B		C*		Ø D		E*		H	
	ton	kg.	lbs	m	ft.	mm.	inch	mm.	inch	mm.	inch	mm.	inch	mm.	inch	mm.	inch	
H-005	0.5	0.1	0.2	5	16	30	1.2	26	1	28	1.1	10	0.4	25	1	235	9.3	
H-01	1	0.2	0.5	5	16	30	1.2	26	1	28	1.1	10	0.4	25	1	235	9.3	
H-0125	1.25	0.2	0.5	5	16	30	1.2	26	1	28	1.1	10	0.4	25	1	235	9.3	
H-016	1.6	0.5	1	5	16	30	1.2	26	1	28	1.1	10	0.4	25	1	235	9.3	
H-02	2	0.5	1	5	16	40	1.6	33	1.3	36	1.4	13	0.5	34	1.3	279	11	
H-025	2.5	0.5	1	5	16	40	1.6	33	1.3	36	1.4	13	0.5	34	1.3	279	11	
H-03	3	0.5	1	5	16	40	1.6	33	1.3	36	1.4	13	0.5	34	1.3	279	11	
H-032	3.2	0.5	1	5	16	40	1.6	33	1.3	36	1.4	13	0.5	34	1.3	279	11	
H-05	5	1	2	5	16	50	2	43	1.7	34	1.4	16	0.6	41	1.6	334	13.2	
H-10	10	2	5	5	16	82	3.2	68	2.7	58	2.3	25	1	56	2.2	440	17.3	
H-12	12.5	2	5	5	16	82	3.2	68	2.7	58	2.3	25	1	56	2.2	440	17.3	
H-15	15	2	5	5	16	104	4.1	82	3.2	64	2.5	33	1.3	57	2.2	508	20	
H-20	20	5	10	5	16	137	5.3	111	4.3	79	3.1	41	1.6	71	2.8	621	24.5	
H-25	25	5	10	5	16	169	6.6	146	5.7	91	3.6	51	2	94	3.7	719	28.3	
H-30	30	5	10	5	16	169	6.6	146	5.7	91	3.6	51	2	94	3.7	719	28.3	
H-315	31.5	5	10	5	16	169	6.6	146	5.7	91	3.6	51	2	94	3.7	719	28.9	
H-32	32	5	10	5	16	169	6.6	146	5.7	89	3.5	51	2	87	3.4	643	25.3	

> The company reserves the right to make changes without notice.

* C & E dimensions subject to change. For current dimensions - contact us.

OPTIONS



- > 1 or 2 user-adjustable set points
- > Additional 0.5"/12mm LCD display with cable connection to indicator or wireless
- > Additional 1"/25mm LCD display with cable connection to indicator or wireless
- > Additional 2"/50mm LCD display with cable connection to indicator or wireless
- > Additional 5"/125mm LED display with cable connection to indicator or wireless
- > Additional extension cable in 15ft/5m increments
- > Analog output: 0 to 3V
- > Analog output: 4 to 20 mA
- > Dampened display for unstable loads
- > Automatic/Manual Data Logger - Up to 50,000 measurements
- > IP 67 load cell with special offshore capability
- > Longer extension cable in 15ft/5m increments
- > Number of measurements per second: 1, 2, 3, factory set
- > Real-time clock: date, hour, minute, second adds time stamp to RS-232 output
- > Rechargeable batteries with an external charger
- > RS-232 - continuous or on demand data output, user-selectable
- > RS-485 - continuous or on demand data output, user-selectable
- > Totalizer
- > Totalizer with Data Logging
- > USB